

## Heatsinks for Quarter Brick DC-DC Converters

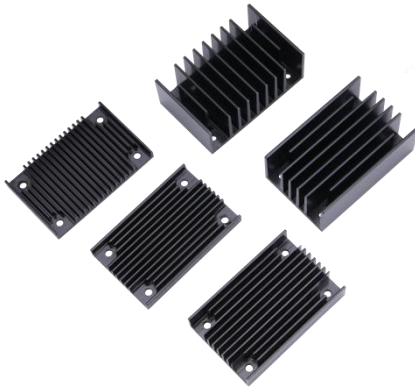

### Features

- Reduce pressure drop and improve thermal performance of modules
- Compatible with DOSA Pin Converters
- Various sizes and fin orientation
- High performance thermal mounting pads available
- Optional packaging and accessories

### Part Numbering System

HS	□□□	□	Q	A	-	□
Series Name	Height	Orientations	Brick Size	X	-	Optional
Heatsink	<b>060:</b> 6.0mm(0.24") <b>114:</b> 11.4mm(0.45") <b>229:</b> 22.9mm(0.90")	<b>L:</b> Lengthwise <b>C:</b> Crosswise	<b>Q:</b> For quarter brick converters	<b>A:</b> Version No.	-	Optional packaging and accessories

### Selection Guide

Part No.	Height (mm)	Orientations	Brick Size	Version
HS060LQA	6.0	Lengthwise	1/4	A
HS060CQA	6.0	Crosswise	1/4	A
HS114LQA	11.4	Lengthwise	1/4	A
HS114CQA	11.4	Crosswise	1/4	A
HS229LQA	22.9	Lengthwise	1/4	A
HS229CQA	22.9	Crosswise	1/4	A

## Characteristics Curves

HSxxxLQA

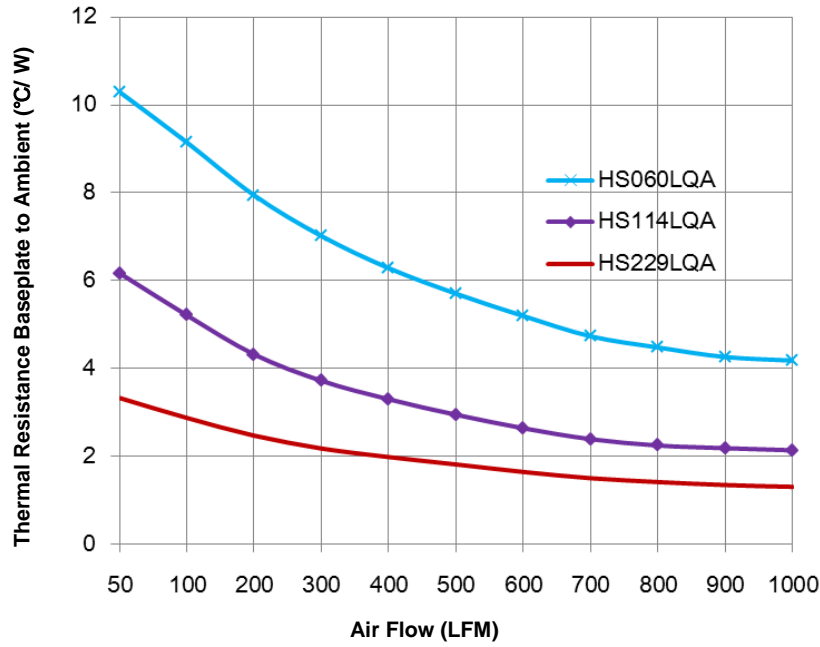

HSxxxCQA

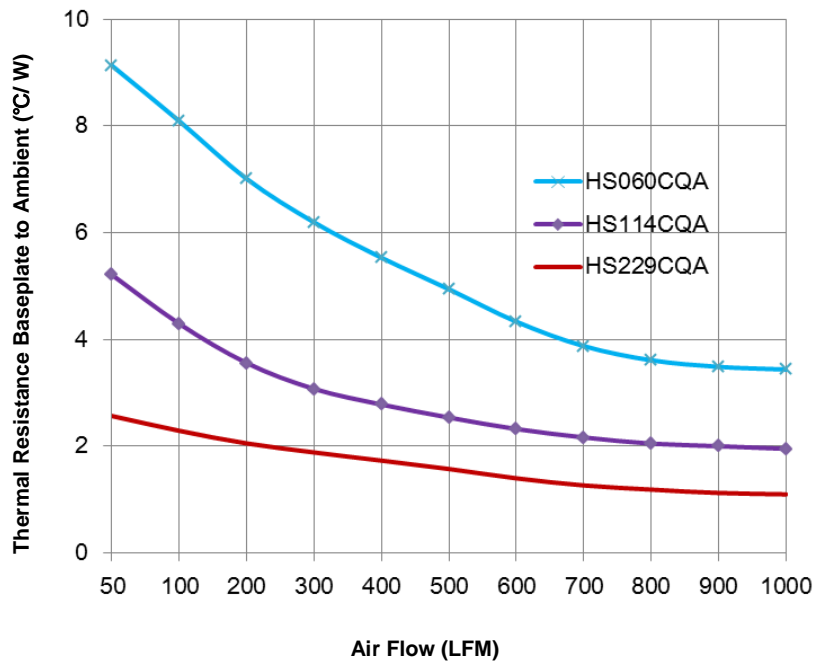

**Mechanical Drawing**

HSxxxLQA

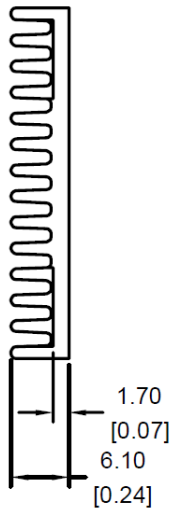
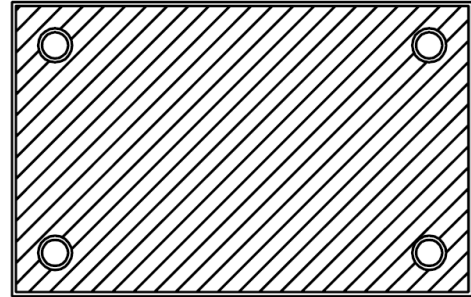
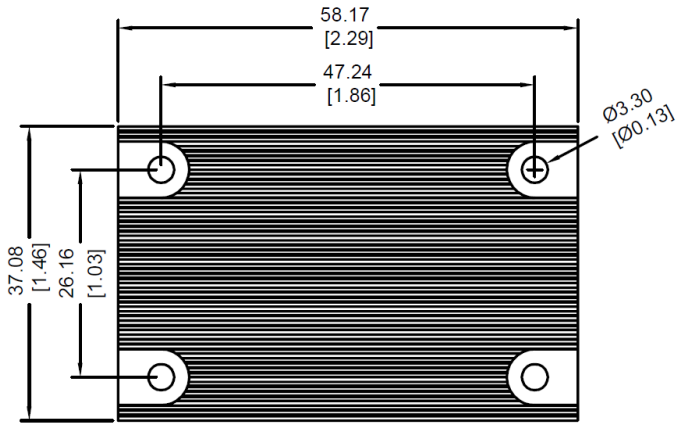

HS060LQA

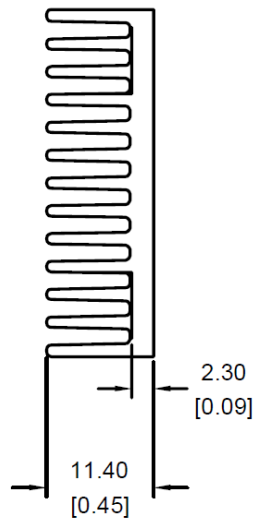

HS114LQA

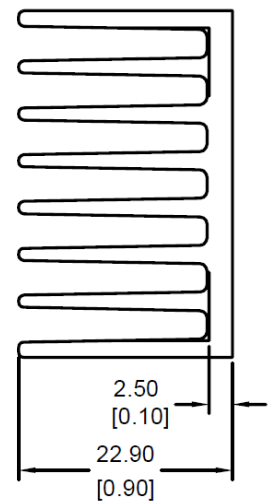

HS229LQA

HSxxxCQA

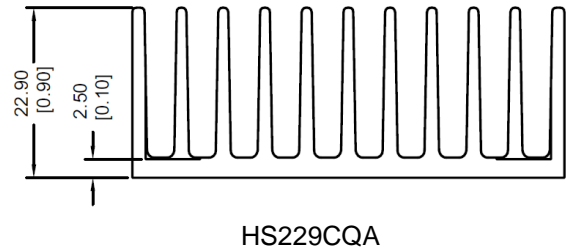
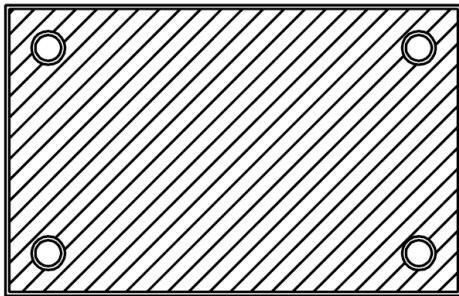
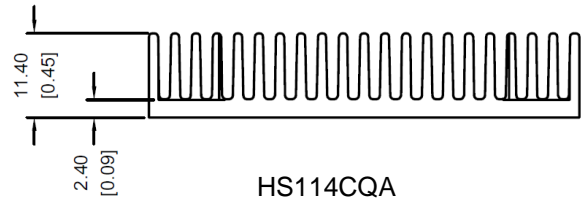
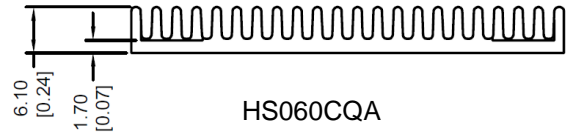
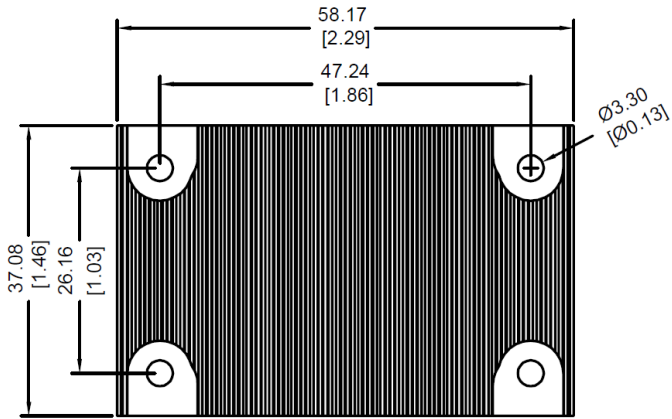

**Notes:**

- 1) All dimensions in mm (inches):  
Tolerances: .xx +/- 0.25 (.xxx +/- 0.010)
- 2) If M3 screws are used to attach a heatsink to the baseplate, the screw length from the surface with fins of the heatsink going down should not exceed 5.5 mm (0.216") max